

DRAWING IS PRODUCED USING THE IRISH TRANSVERSE MERCATOR (ITM) GEOGRAPHIC COORDINATE SYSTEM **A1**

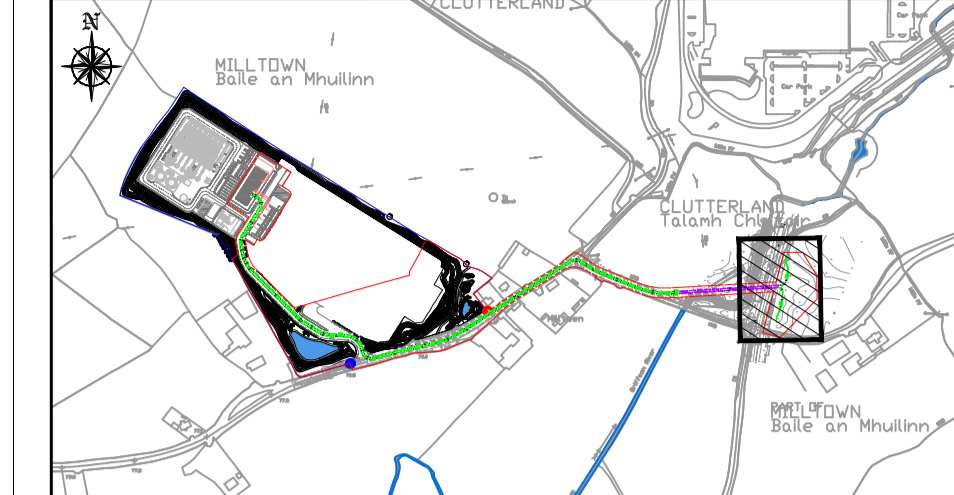

KEYPLAN
N.T.S

- LEGEND:**
- PLANNING BOUNDARY
 - PROPERTY BOUNDARY
 - PROPOSED 110KV GRID CONNECTION
 - PROPOSED HV CONDUITS
 - PROPOSED HDD (HORIZONTAL DIRECTIONAL DRILL)
 - EXISTING GRIFFEEN RIVER
 - PROPOSED SUBSTATION

Rev	Description	Drawn	Checked	Date
P04	ISSUE FOR PLANNING	DW	LP	15.03.21
P03	FOR INFORMATION	DW	LP	10.03.21
P02	FOR INFORMATION	DW	LP	23.02.21
P01	FOR INFORMATION	DW	LP	17.02.21

Clifton Scannell Emerson Associates
Clifton Scannell Emerson Associates Limited
Consulting Engineers,
Seafor Lodge,
Castledawson Avenue,
Blackrock, Co. Dublin,
Ireland, A94 P768
T: +353 1 288 5006
F: +353 1 283 3466
E: info@csea.ie
W: www.csea.ie

DATA & POWER HUB SERVICES LTD	
Client	SERVICES DUE DILIGENCE
Project	SITE R120
Dwg. Title	PROPOSED GRID CONNECTION CABLE ROUTE SHEET 05
Drawn By	DW Date FEB 2021
Checked By	RG Scale 1:200@ A1 20_147
Project Code	Originator Zone/Phase Level Type Role Dwg. No.
20_147 - CSE - GEN - XX - DR - C - 2125	
S2	FOR INFORMATION
Status Code	Suitability Description
P04	PLANNING
Revision	Project Status

PLAN 8